

**1310nm 5mW DFB Coaxial Pigtailed Laser Diode with Single Mode Fiber (9um Fiber Core)**
**1310nm SM Fiber Coupled LD with Single Mode Fiber (SM Fiber)**
**WSLP-1310-005m-9-DFB**
**Wavespectrum Laser Group**
**www.wavespectrum-laser.com**

PARAMETER	SYMBOL	VALUE	UNIT
LD Reverse Voltage	$V_r$	2.0	V
PD Reverse Voltage	$V_{r(PD)}$	15	V
Operating Temperature	$T_{op}$	-20 ~ +50	°C
Storage Temperature	$T_{stg}$	-40 ~ +100	°C
Lead soldering temperature (10 sec.)	$T_{is}$	260	°C
<b>Features:</b> <ul style="list-style-type: none"> <li>● 1310nm</li> <li>● DFB Laser Diode</li> <li>● Built-in Photodiodes</li> <li>● 9um SM Fiber</li> <li>● Isolation Optional</li> <li>● Coaxial/Receptacle Package</li> </ul>			
<b>Applications:</b> <ul style="list-style-type: none"> <li>● Test Equipments</li> <li>● Optical Transmitter of Analog Signal</li> <li>● Optical Transmitter of Data Signal</li> </ul>			
<b>Specifications</b>		<b>WSLP-1310-005m-9-DFB</b>	
		Min	Type
Center Wavelength@25°C		±3nm	1310nm
Laser Type		DFB	
Output Power		----	5mW
Fiber Core		9um	
Threshold Current (Typ.) $I_{th}$		----	5mA
Operating Current		----	60mA
Operating Voltage		----	1.4V
Spectral Width(FWHM)		----	3nm
SMSR		----	35dB
Monitor Current		0.1mA	----
PD Capacitance		----	10pF
PD Dark Current		----	0.1uA
Package Style		Coaxial or B85	
Recommended Operation Temperature		25°C	
Connector		FC/SC/SMA905	

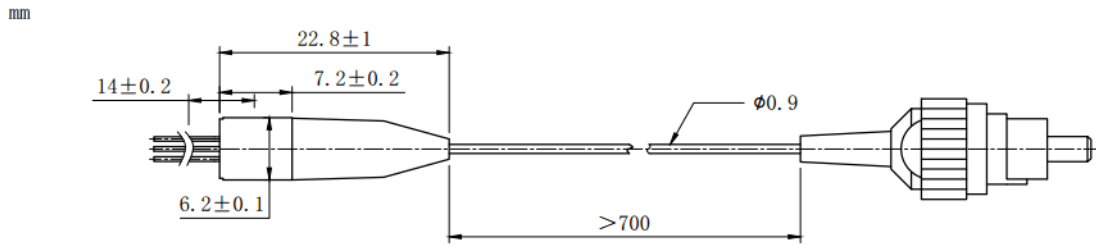
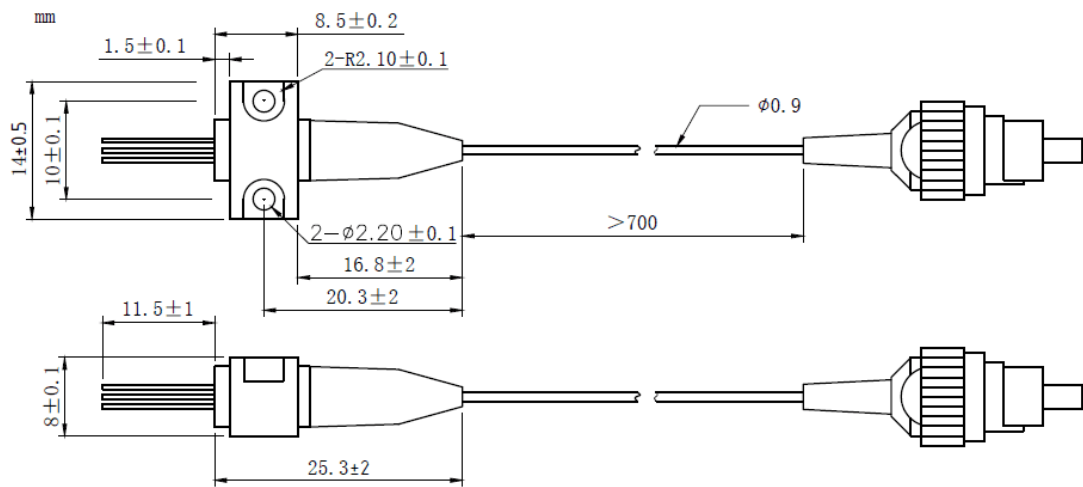
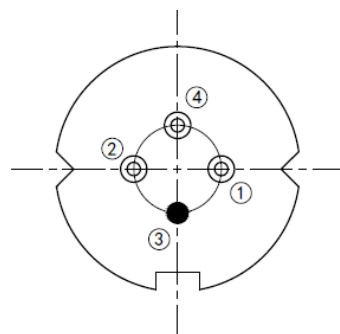

**Coaxial Package View: (Part Number: WSLP-1310-005m-9-DFB)**

**B85 Package View: (Part Number: WSLP-1310-005m-9-B-DFB)**

**Pin Bottom View (A-Type)**

PIN 1	PD(+)
PIN 2	LD(-)
PIN 3	LD(+), CASE
PIN 4	PD(-)



Electrically shorten LD module and store in non-extreme conditions.  
Suggest using the constant current power supply.

