

**1310nm 15mW DFB Coaxial Pigtailed Laser Diode (LD) with 9um Single Mode Fiber**
**1310nm High Power SM Fiber Coupled Diode Laser with Single Mode Fiber (SM Fiber)**
**WSLP-1310-015m-9-DFB**
**Wavespectrum Laser Group**
**www.wavespectrum-laser.com**

| PARAMETER  | SYMBOL      | VALUE  | UNIT   |       |
|--|-------------|--|--------|-------|
| LD Reverse Voltage   | $V_r$       | 2.0  | V      |       |
| PD Reverse Voltage   | $V_{r(PD)}$ | 15   | V      |       |
| Operating Temperature  | $T_{op}$    | -20 ~ +50  | °C     |       |
| Storage Temperature  | $T_{stg}$   | -40 ~ +100   | °C     |       |
| Lead soldering temperature (10 sec.)   | $T_{is}$    | 260  | °C     |       |
| <b>Features:</b> <ul style="list-style-type: none"> <li>• 1310nm</li> <li>• DFB Laser Diode</li> <li>• Built-in Photodiodes</li> <li>• 9um SM Fiber</li> <li>• Isolation Optional</li> <li>• Coaxial or B85 Package</li> </ul> |             |  |        |       |
| <b>Applications:</b> <ul style="list-style-type: none"> <li>• Test Equipments</li> <li>• Optical Transmitter of Analog Signal</li> <li>• Optical Transmitter of Data Signal</li> </ul>   |             |  |        |       |
| <b>Specifications</b>  |             | <b>WSLP-1310-015m-9-DFB</b>  |        |       |
|  |             | Min  | Type   | Max   |
| Center Wavelength@25°C   |             | ±3nm   | 1310nm | ±10nm |
| Laser Type   |             | DFB  |        |       |
| Output Power   |             | ----   | 15mW   | ----  |
| Fiber Core   |             | 9um SM Fiber   |        |       |
| Threshold Current (Typ.) $I_{th}$  |             | ----   | 5mA    | 15mA  |
| Operating Current  |             | ----   | 80mA   | 100mA |
| Operating Voltage  |             | ----   | 1.4V   | 1.7V  |
| Spectral Width(FWHM)   |             | ----   | ----   | 3nm   |
| SMSR   |             | ----   | 35dB   | ----  |
| Monitor Current  |             | 0.1mA  | ----   | ----  |
| PD Capacitance   |             | ----   | 10pF   | 20pF  |
| PD Dark Current  |             | ----   | ----   | 0.1uA |
| Package Style  |             | Coaxial or B85   |        |       |
| Recommended Operation Temperature  |             | 25°C   |        |       |
| Connector  |             | FC/SC/SMA905   |        |       |

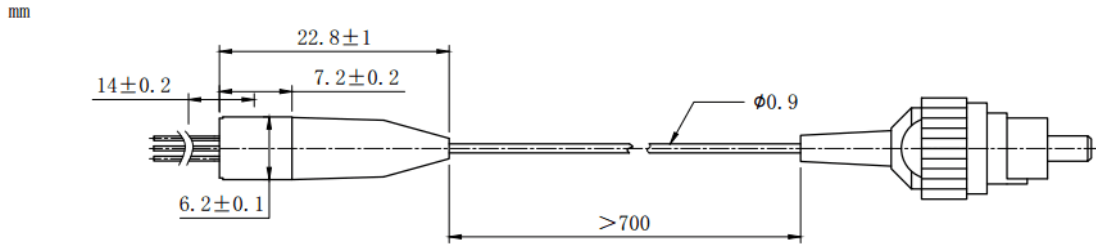

### Coaxial Package View: (Part Number: WSLP-1310-015m-9-DFB)



### B85 Package View: (Part Number: WSLP-1310-015m-9-B-DFB)

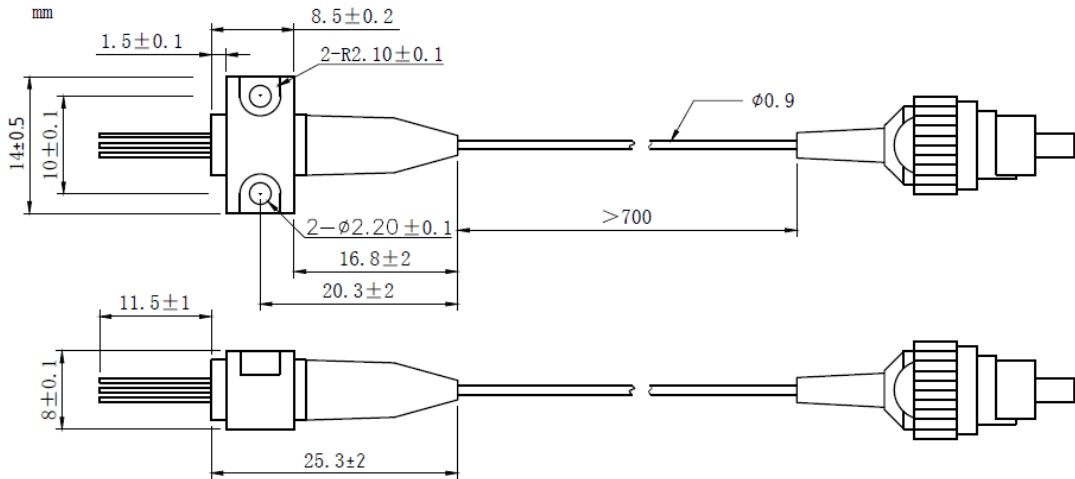

### Pin Bottom View (A-Type)

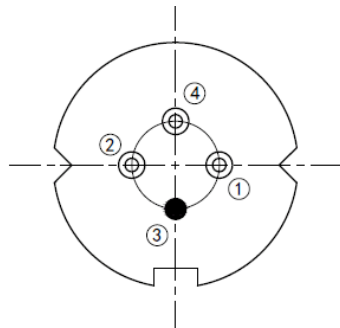

|       |              |
|-------|--------------|
| PIN 1 | PD (+)       |
| PIN 2 | LD (-)       |
| PIN 3 | LD (+), CASE |
| PIN 4 | PD (-)       |



Electrically shorten LD module and store in non-extreme conditions.  
Suggest using the constant current power supply.

