

980nm 15mW SM Coaxial Pigtailed Laser Diode with 9um SMF28 | Built-in Photodiode
976nm~980nm SM Fiber Coupled LD with 9um SM Fiber | With PD
WSLP-980-015m-9-PD
Wavespectrum Laser Group
www.wavespectrum-laser.com
en.wavespectrum-laser.com.cn

980nm Pigtailed Diode Laser		15mW/9um Fiber	
PARAMETER	SYMBOL	VALUE	UNIT
Reverse Voltage	V_r	2.0	V
Operating Temperature	T_{op}	-10~+40	°C
Storage Temperature	T_{stg}	-40~+85	°C
Lead soldering temperature (10 sec.)	T_{is}	260	°C
Features: <ul style="list-style-type: none"> ● 976nm ● 9um Fiber ● Coaxial or B82 Package ● Built-in PD 			
Applications: <ul style="list-style-type: none"> ● Medical Laser Treatment ● Sensor ● Others 			
Specifications	WSLP-980-015m-9-PD		
	Min	Type	Max
Center Wavelength@25°C	±5nm	976nm	±15nm
Recommended Operating Temperature	25°C		
Output Power	----	15mW	----
Fiber Type	SMF-28		
Fiber Core	9um		
Monitor Current	----	0.2mA	----
PD Reverse Voltage	----	----	30V
Fiber Connector	FC/SC/SMA905		
Fiber Length	----	80cm	100cm
Threshold Current (Typ.)	----	15mA	30mA
Operating Current (Typ.)	----	75mA	85mA
Operating Voltage	----	1.7V	2.2V
Package Style	Coaxial or B82		
Photodiodes	Built-in		

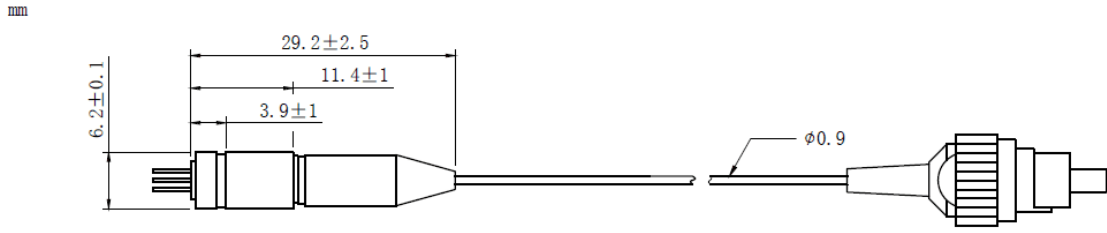
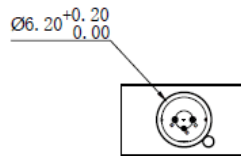
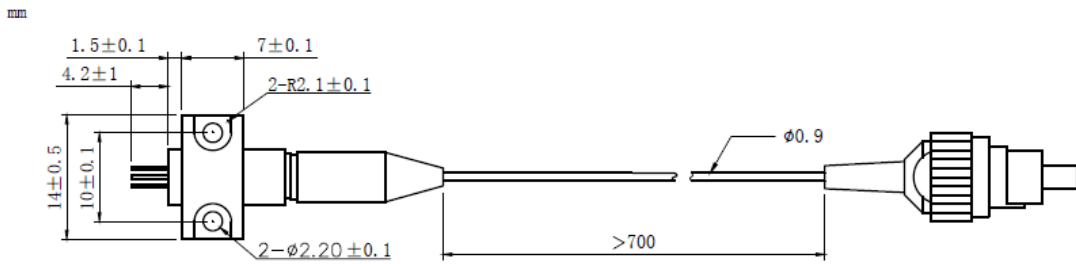
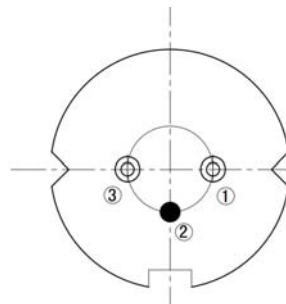

Coaxial Package View: (Part Number: WSLP-980-015m-9-PD)

B82 Package View: (Part Number: WSLP-980-015m-9-B-PD)

PIN Bottom View:

1	LD(-)
2	LD(+)&PD(-)
3	PD(+)



Electrically shorten LD module and store in non-extreme conditions.
Suggest using the constant current power supply.

