

880nm 2mW~3mW SM Coaxial Pigtailed Laser Diode with 9um Fiber | Built-in Photodiode
870nm~880nm SM Fiber Coupled LD with SMF-28 Fiber (9um Fiber) | With PD
WSLP-880-002m-9-PD
Wavespectrum Laser Group
www.wavespectrum-laser.com

880nm Pigtailed Diode Laser		2mW/9um Fiber		en.wavespectrum-laser.com.cn	
PARAMETER	SYMBOL	VALUE		UNIT	
Reverse Voltage	V_r	2.0		V	
Operating Temperature	T_{op}	-10~+60		°C	
Storage Temperature	T_{stg}	-40~+85		°C	
Lead soldering temperature (10 sec.)	T_{is}	260		°C	
Features: <ul style="list-style-type: none"> ● 880nm ● 9um Fiber ● Coaxial or B82 Package ● Built-in PD 					
Applications: <ul style="list-style-type: none"> ● Medical Laser Treatment ● Sensor ● Others 					
Specifications	WSLP-880-002m-9-PD				
	Min	Type	Max		
Center Wavelength@25°C	870nm	880nm	890nm		
Recommended Operating Temperature	25°C				
Output Power	----	2mW	----		
Fiber Type	SMF-28				
Fiber Core	9um				
Monitor Current	----	0.3mA	----		
PD Reverse Voltage	----	----	30V		
Fiber Connector	FC/SC/SMA905				
Fiber Length	----	80cm	100cm		
Threshold Current (Typ.)	----	9mA	16mA		
Operating Current (Typ.)	----	20mA	25mA		
Operating Voltage	----	2.0V	2.6V		
Package Style	Coaxial or B82				
Photodiodes	Built-in				

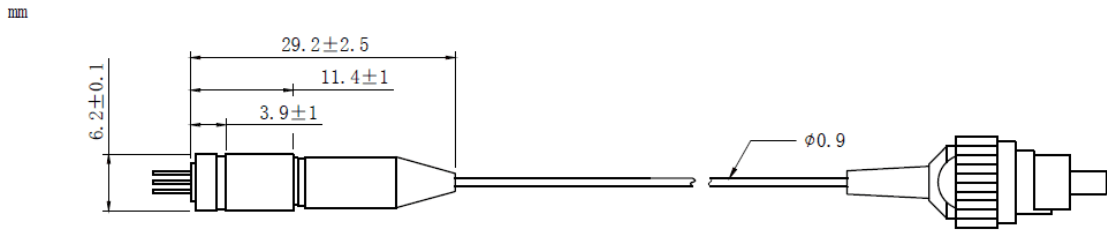
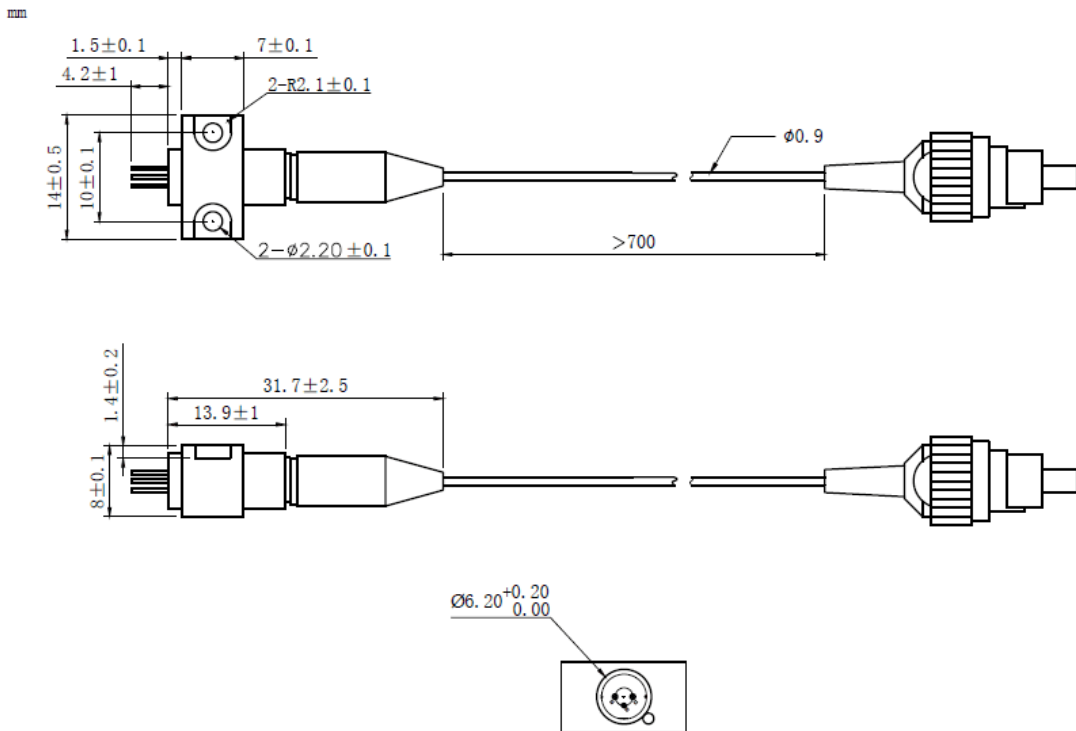
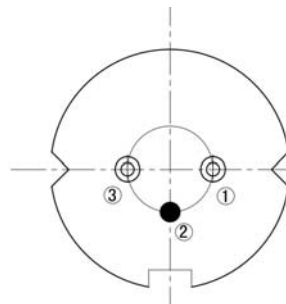

Coaxial Package View: (Part Number: WSLP-880-002m-9-PD)

B82 Package View: (Part Number: WSLP-880-002m-9-B-PD)

PIN Bottom View:

1	LD(-)
2	LD(+)&PD(-)
3	PD(+)



Electrically shorten LD module and store in non-extreme conditions.
Suggest using the constant current power supply.

