

850nm 10mW~15mW SM Coaxial Pigtailed Laser Diode with SMF | Infrared Diode Laser Module
850nm 10mW Fiber Coupled LD with Single Mode Fiber (SM Fiber) | Built-in Photodiode (PD)
WSLP-850-010m-4-PD
Wavespectrum Laser Group
www.wavespectrum-laser.com

850nm Pigtailed Diode Laser		10mW/SM Fiber		en.wavespectrum-laser.com.cn	
PARAMETER	SYMBOL	VALUE		UNIT	
Reverse Voltage	V_r	2.0		V	
Operating Temperature	T_{op}	-10~+50		°C	
Storage Temperature	T_{stg}	-40~+80		°C	
Lead soldering temperature (10 sec.)	T_{is}	260		°C	
Features: <ul style="list-style-type: none"> ● 850nm ● With SM Fiber ● Coaxial or B82 Package ● Built-in PD 					
Applications: <ul style="list-style-type: none"> ● Medical Laser Treatment ● Sensor ● Others 					
Specifications	WSLP-850-010m-4-PD				
	Min	Type	Max		
Center Wavelength@25°C	840nm	850nm	860nm		
Recommended Operating Temperature	25°C				
Output Power	----	10mW	----		
Fiber Type	Single Mode Fiber				
Fiber Core	5um				
Monitor Current	----	0.2mA	----		
PD Reverse Voltage	----	----	30V		
Fiber Connector	FC/SC/SMA905				
Fiber Length	----	80cm	100cm		
Threshold Current (Typ.)	----	15mA	30mA		
Operating Current (Typ.)	----	90mA	110mA		
Operating Voltage	----	2.3V	2.8V		
Package Style	Coaxial or B82				
Photodiodes	Built-in				

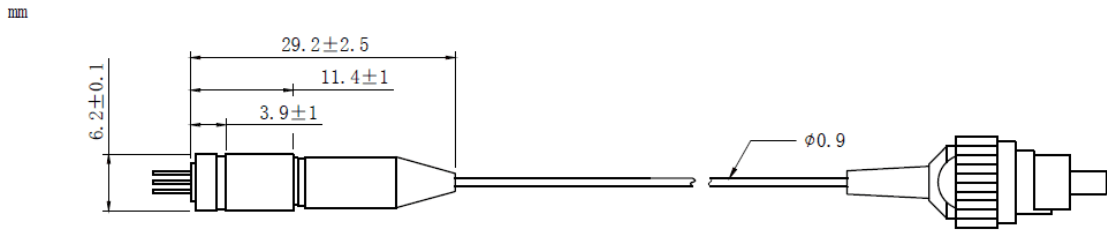
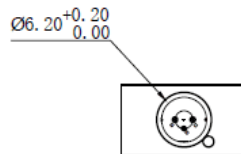
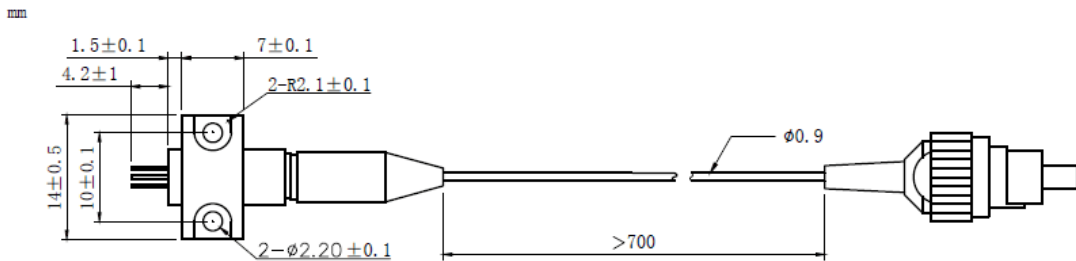
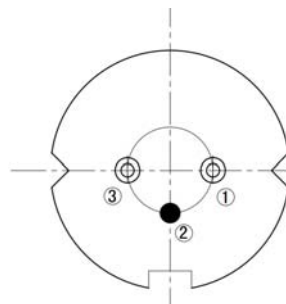

Coaxial Package View: (Part Number: WSLP-850-010m-4-PD)

B82 Package View: (Part Number: WSLP-850-010m-4-B-PD)

PIN Bottom View:

1	LD(-)
2	LD(+)&PD(-)
3	PD(+)



Electrically shorten LD module and store in non-extreme conditions.
Suggest using the constant current power supply.

