

830nm 100mW SM Fiber Coupled LD with 9um Fiber (SMF-28) | Built-in Photodiode
820nm~830nm~840nm 100mW High Power Coaxial Pigtailed Laser Diode with SMF28 Fiber | With PD
WSLP-830-100m-9-PD
Wavespectrum Laser Group
www.wavespectrum-laser.com

830nm Pigtailed Diode Laser		100mW/9um		Wavespectrum Laser Group	
PARAMETER	SYMBOL	VALUE		UNIT	
Reverse Voltage	V_r	2.0		V	
Operating Temperature	T_{op}	-10~+60		°C	
Storage Temperature	T_{stg}	-40~+85		°C	
Lead soldering temperature (10 sec.)	T_{is}	260		°C	
Features: <ul style="list-style-type: none"> ● 830nm ● With 9um Fiber ● Coaxial or B82 Package ● Built-in PD 					
Applications: <ul style="list-style-type: none"> ● Medical Laser Treatment ● Others 					
Specifications	WSLP-830-100m-9-PD				
	Min	Type	Max		
Center Wavelength@25°C	±5nm	830nm	±15nm		
Recommended Operating Temperature	25°C				
Output Power	----	100mW	----		
Fiber Type	SMF-28				
Fiber Core	9um				
Monitor Current	----	0.3mA	----		
PD Reverse Voltage	----	----	30V		
Fiber Connector	FC/SC/SMA905				
Fiber Length	----	80cm	100cm		
Threshold Current (Typ.)	----	35mA	55mA		
Operating Current (Typ.)	----	220mA	240mA		
Operating Voltage	----	2.4V	3.0V		
Package Style	Coaxial or B82				
PD	Built-in				

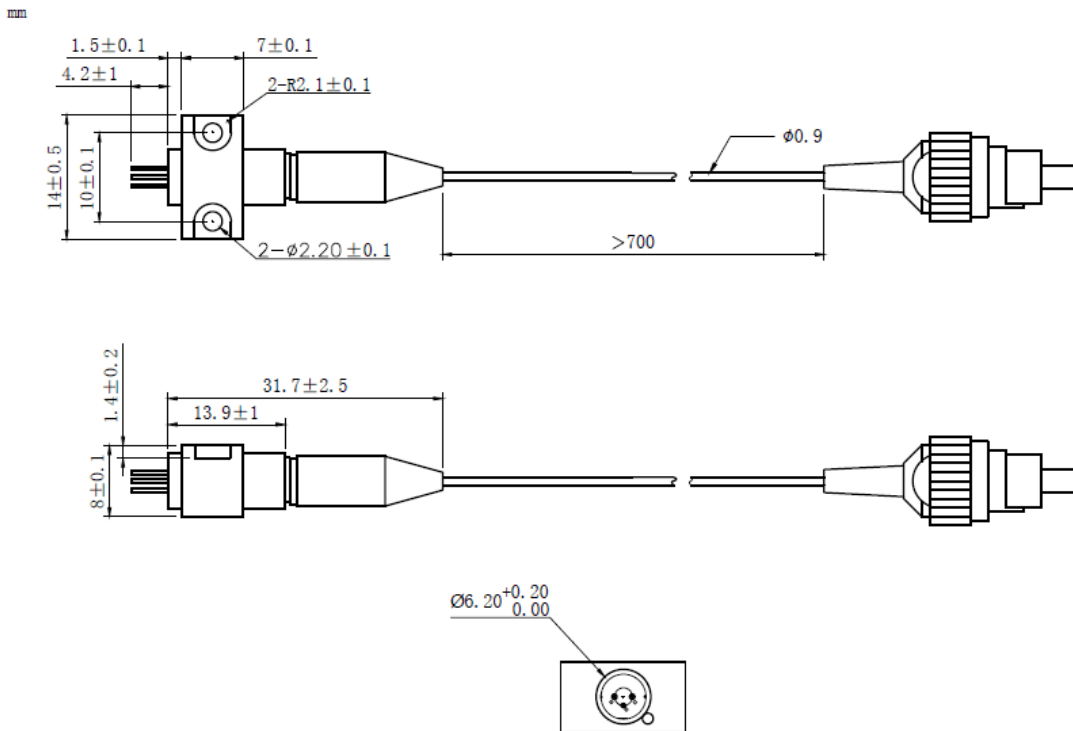
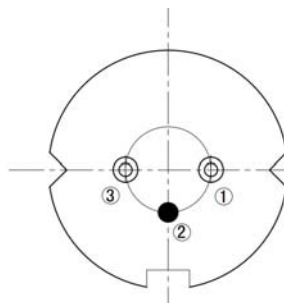

Coaxial Package View: (Part Number: WSLP-830-100m-9-PD)

B82 Package View: (Part Number: WSLP-830-100m-9-B-PD)

PIN Bottom View:

1	LD(-)
2	LD(+)&PD(-)
3	PD(+)



Electrically shorten LD module and store in non-extreme conditions.
Suggest using the constant current power supply.

