

670nm 3mW SM Coaxial Pigtailed Laser Diode with SMF | 4um SMF| Built-in Photodiode| Heat-sink Optional
670nm~675nm SM Fiber Coupled LD with Single Mode Fiber | With PD | Single Mode Beam
WSLP-670-003m-4-PD **Wavespectrum Laser Group** **www.wavespectrum-laser.com**

670nm Pigtailed Diode Laser 3mW/SMF **en.wavespectrum-laser.com.cn**

PARAMETER	SYMBOL	VALUE	UNIT
Reverse Voltage	V_r	2.0	V
Operating Temperature	T_{op}	-10~+60	°C
Storage Temperature	T_{stg}	-40~+85	°C
Lead soldering temperature (10 sec.)	T_{is}	260	°C

Features: <ul style="list-style-type: none"> ● 670nm ● With SM Fiber ● Coaxial or B82 Package ● Built-in PD 	
Applications: <ul style="list-style-type: none"> ● Medical Laser Treatment ● Others 	

Specifications	WSLP-670-003m-4-PD		
	Min	Type	Max
Center Wavelength@25°C	±5nm	670nm	±10nm
Recommended Operating Temperature	25°C		
Output Power	----	3mW	----
Fiber Type	Single Mode Fiber		
Fiber Core	4um		
Monitor Current	----	0.5mA	----
PD Reverse Voltage	----	----	30V
Fiber Connector	FC/SC/SMA905		
Fiber Length	----	80cm	100cm
Threshold Current (Typ.)	----	20mA	30mA
Operating Current (Typ.)	----	35mA	40mA
Operating Voltage	----	2.3V	2.8V
Package Style	Coaxial or B82		
PD	Built-in		

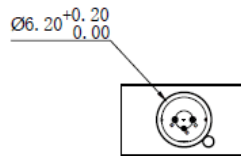
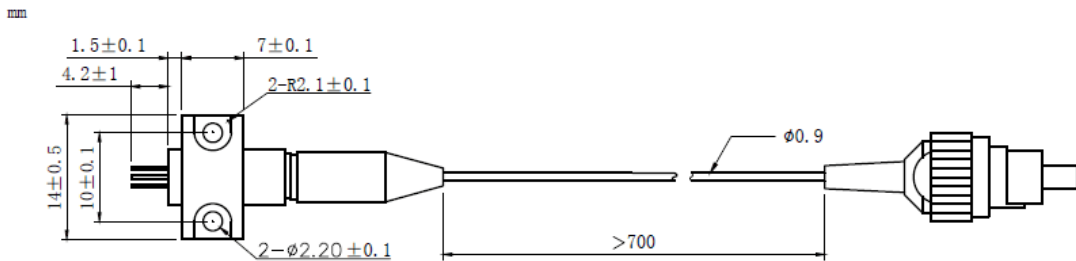
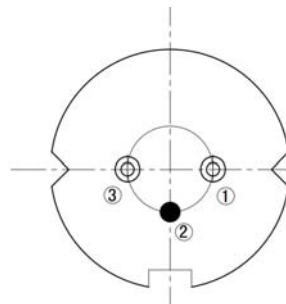

Coaxial Package View: (Part Number: WSLP-670-003m-4-PD)

B82 Package View: (Part Number: WSLP-670-003m-4-B-PD)

PIN Bottom View:

1	LD(-)
2	LD(+)&PD(-)
3	PD(+)



Electrically shorten LD module and store in non-extreme conditions.
Suggest using the constant current power supply.

