

**650nm~660nm 10mW SM Coaxial Pigtailed Laser Diode with PMF | Built-in Photodiodes (PD)**
**660nm SM Fiber Coupled LD with Polarization Maintaining Fiber |With PD**
**WSLP-650-010m-PM-PD**
**Wavespectrum Laser Group**
**www.wavespectrum-laser.com**

658nm Pigtailed Diode Laser		10mW/PM Fiber		en.wavespectrum-laser.com.cn	
PARAMETER	SYMBOL	VALUE		UNIT	
Reverse Voltage	$V_r$	2.0		V	
Operating Temperature	$T_{op}$	-10~+60		°C	
Storage Temperature	$T_{stg}$	-40~+85		°C	
Lead soldering temperature (10 sec.)	$T_{is}$	260		°C	
<b>Features:</b> <ul style="list-style-type: none"> <li>● 650nm</li> <li>● 4um PM Fiber</li> <li>● High Reliability</li> <li>● High Polarization Extinction Ratio</li> </ul>					
<b>Applications:</b> <ul style="list-style-type: none"> <li>● Medical Laser Treatment</li> <li>● Others</li> </ul>					
<b>Specifications</b>	<b>WSLP-650-010m-PM-PD</b>				
	Min	Type	Max		
Center Wavelength@25°C	650nm	658nm	670nm		
Recommended Operating Temperature	25°C				
Output Power	----	10mW	----		
Fiber Type	Polarization Maintaining Fiber				
Fiber Core	4um				
Polarization Extinction Ratio	13dB	15dB	----		
Monitor Current	----	0.3mA	----		
Fiber Length	----	80cm	100cm		
Threshold Current (Typ.)	----	45mA	70mA		
Operating Current (Typ.)	----	100mA	120mA		
Operating Voltage	----	2.7V	3.2V		
Fiber Connector	FC/APC				
Package Style	Coaxial or B82				
High Polarization Extinction Ratio (PER) Version Laser Module is also available, please contact us.					

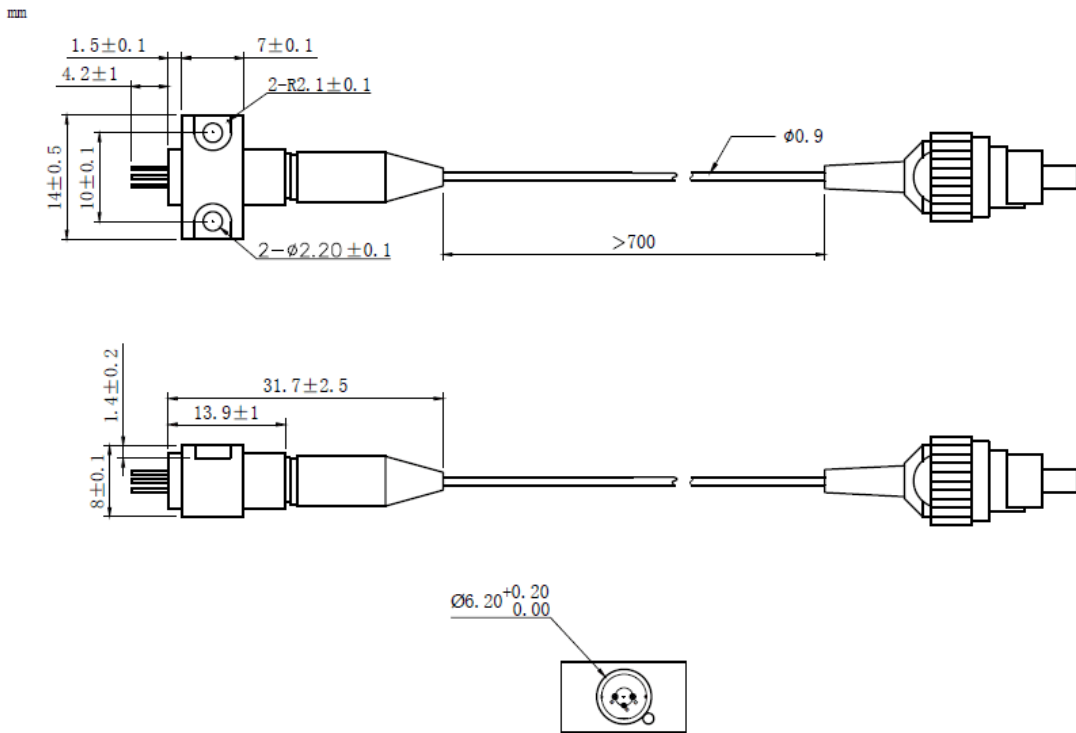
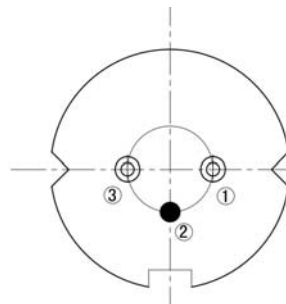

**Coaxial Package View: (Part Number: WSLP-650-010m-PM-PD)**

**B82 Package View: (Part Number: WSLP-650-010m-PM-B-PD)**

**PIN Bottom View:**

1	LD(-)
2	LD(+)&PD(-)
3	PD(+)



Electrically shorten LD module and store in non-extreme conditions.  
Suggest using the constant current power supply.

