

635nm~638nm 5mW Single Mode Fiber Coupled Diode Laser with Photodiode (PD)
635nm 5mW Coaxial Pigtailed Laser Diode with 4um Single Mode Fiber (SM Fiber)

WSLP-635-005m-4-PD

Wavespectrum Laser Group

www.wavespectrum-laser.com

635nm Pigtailed Diode Laser	5mW/SMF	en.wavespectrum-laser.com.cn
-----------------------------	---------	------------------------------

PARAMETER	SYMBOL	VALUE	UNIT
Reverse Voltage	V_r	2.0	V
Operating Temperature	T_{op}	-10~+50	°C
Storage Temperature	T_{stg}	-40~+85	°C
Lead soldering temperature (10 sec.)	T_{is}	260	°C

Features:

- 635nm
- 4um SM Fiber
- Coaxial or B82 Package
- Built-in PD

Applications:

- Medical Laser Treatment
- Aiming Beam
- Others

Specifications
WSLP-635-005m-4-PD

	Min	Type	Max
Center Wavelength@25°C	630nm	638nm	645nm
Recommended work Temperature	25°C		
Output Power	----	5mW	----
Fiber Type	Single Mode Fiber		
Fiber Core	4um		
Monitor Current	----	0.3mA	----
PD Reverse Voltage	----	----	30V
Fiber Connector	FC/SC/SMA905		
Fiber Length	----	80cm	100cm
Threshold Current	----	40mA	60mA
Operating Current	----	80mA	100mA
Operating Voltage	----	2.4V	2.7V
Package Style	Coaxial or B82		
PD	Built-in		

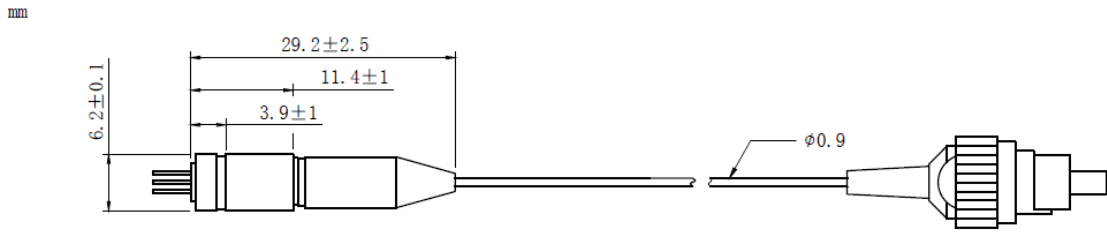
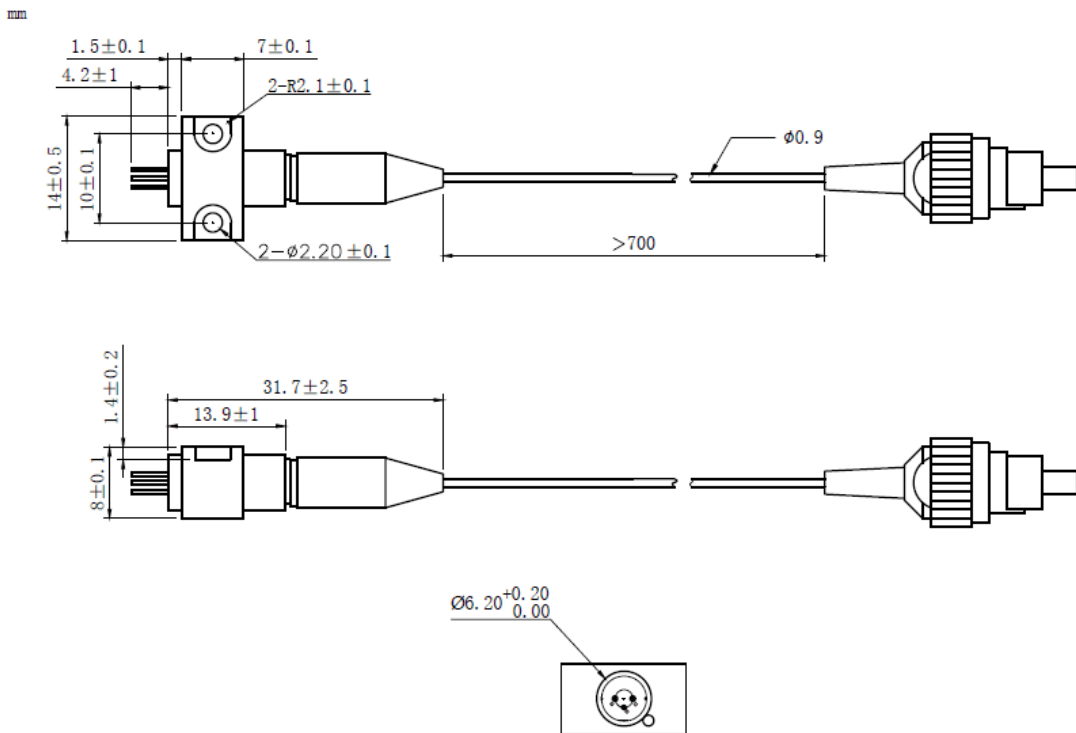
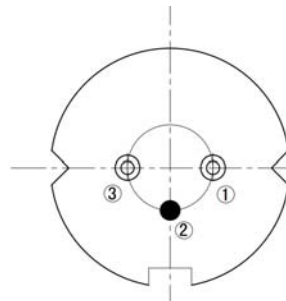

Coaxial Package View: (Part Number: WSLP-635-005m-4-PD)

B82 Package View: (Part Number: WSLP-635-005m-4-B-PD)

PIN Bottom View:

1	LD(-)
2	LD(+)&PD(-)
3	PD(+)



Electrically shorten LD module and store in non-extreme conditions.
Suggest using the constant current power supply.

