

**520nm 10mW SM Coaxial Fiber Coupled Laser Diode with SMF | Green LD Module**
**515nm~520nm 10mW SM Pigtailed LD with Single Mode Fiber (SM Fiber)**

WSLP-520-010m-4

Wavespectrum Laser Group

[www.wavespectrum-laser.com](http://www.wavespectrum-laser.com)
[en.wavespectrum-laser.com.cn](http://en.wavespectrum-laser.com.cn)

520nm Pigtailed Diode Laser		10mW/SM Fiber	
PARAMETER	SYMBOL	VALUE	UNIT
Reverse Voltage	$V_r$	2.0	V
Operating Temperature	$T_{op}$	-20 ~ +60	°C
Storage Temperature	$T_{stg}$	-40 ~ +85	°C
Lead soldering temperature (10 sec.)	$T_{is}$	260	°C
<b>Features:</b> <ul style="list-style-type: none"> <li>520nm Green Diode Laser</li> <li>3um SM Fiber</li> <li>Coaxial or B82 package</li> </ul>			
<b>Applications:</b> <ul style="list-style-type: none"> <li>Medical Laser Treatment</li> <li>Others</li> </ul>			
<b>Specifications</b>	<b>WSLP-520-010m-4</b>		
	Min	Type	Max
Center Wavelength@25°C	+/-5nm	520nm	+/-10nm
Spectral Width (FWHM)	----	2.0nm	----
Output Power	----	10mW	----
Fiber Type	Single Mode Fiber		
Fiber Core	3um		
Recommend Operating Temperature	25°C		
Fiber Connector	FC/SC/SMA905		
Fiber Length	----	80cm	100cm
Threshold Current	----	40mA	75mA
Operating Current	----	180mA	200mA
Operating Voltage	----	7.0V	8.0V
Package Style	Coaxial or B82		



**Coaxial Package View: (Part Number: WSLP-520-010m-4)**

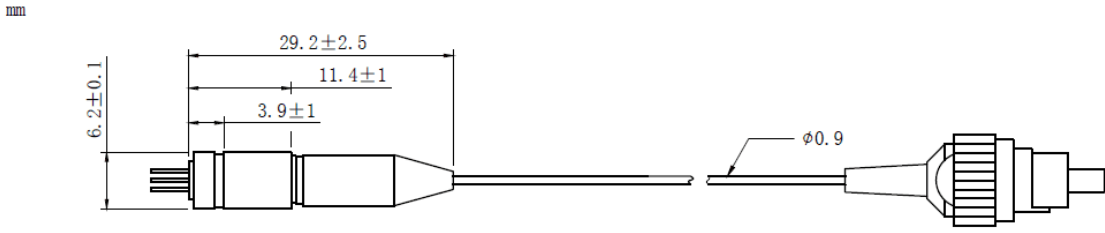

**B82 Package View: (Part Number: WSLP-520-010m-4-B)**

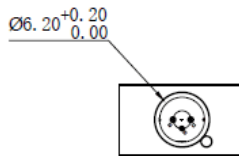
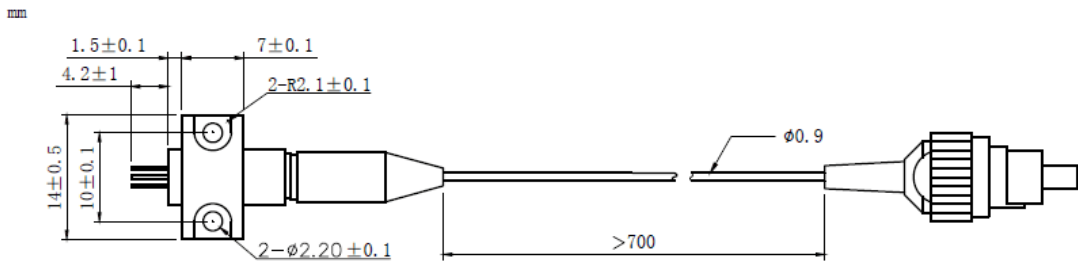

**PIN Bottom View:**

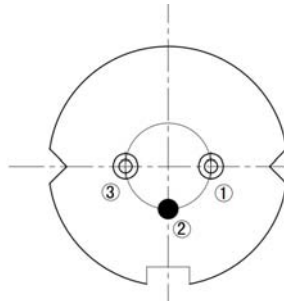

<b>1</b>	<b>LD(+)</b>
<b>2</b>	<b>GND</b>
<b>3</b>	<b>LD(-)</b>



Electrically shorten LD module and store in non-extreme conditions.  
Suggest using the constant current power supply.

