

**505nm 10mW SM Coaxial Diode Laser with Polarization Maintaining Fiber**  
**500nm~505nm~510nm PM Fiber Coupled Laser Diode with SMF | Green LD Module**  
 WSLP-505-010m-PM                      Wavespectrum Laser Group                      www.wavespectrum-laser.com

|                                    |                 |                                     |
|------------------------------------|-----------------|-------------------------------------|
| <b>505nm Pigtailed Diode Laser</b> | <b>10mW/PMF</b> | <b>en.wavespectrum-laser.com.cn</b> |
|------------------------------------|-----------------|-------------------------------------|

| PARAMETER                            | SYMBOL    | VALUE   | UNIT |
|--------------------------------------|-----------|---------|------|
| Reverse Voltage                      | $V_r$     | 2.0     | V    |
| Operating Temperature                | $T_{op}$  | -10~+60 | °C   |
| Storage Temperature                  | $T_{stg}$ | -40~+85 | °C   |
| Lead soldering temperature (10 sec.) | $T_{is}$  | 260     | °C   |

|  |  |
|--|--|
| <p><b>Features:</b></p> <ul style="list-style-type: none"> <li>● 505nm Green Diode Laser</li> <li>● PM Fiber</li> <li>● High Reliability</li> <li>● High Polarization Extinction Ratio</li> </ul> <p><b>Applications:</b></p> <ul style="list-style-type: none"> <li>● Biological Instruments</li> <li>● Analytical Equipment</li> <li>● Others</li> </ul> |  |
|--|--|

| Specifications                  | WSLP-505-010m-PM               |       |       |
|---------------------------------|--------------------------------|-------|-------|
|                                 | Min                            | Type  | Max   |
| Center Wavelength@25°C          | ±5nm                           | 505nm | ±10nm |
| Spectral Width (FWHM)           | ----                           | 2.0nm | ----  |
| Output Power                    | ----                           | 10mW  | ----  |
| Fiber Type                      | Polarization Maintaining Fiber |       |       |
| Fiber Core                      | 3um                            |       |       |
| Polarization Extinction Ratio   | 13dB                           | 15dB  | ----  |
| Recommend Operating Temperature | 25°C                           |       |       |
| Fiber Connector                 | FC/APC                         |       |       |
| Fiber Length                    | ----                           | 80cm  | 100cm |
| Threshold Current               | ----                           | 50mA  | 90mA  |
| Operating Current               | ----                           | 180mA | 200mA |
| Operating Voltage               | ----                           | 7.5V  | 8.0V  |
| Package Style                   | Coaxial or B82                 |       |       |

High Polarization Extinction Ratio (PER) Version Laser Module is also available, please contact us.

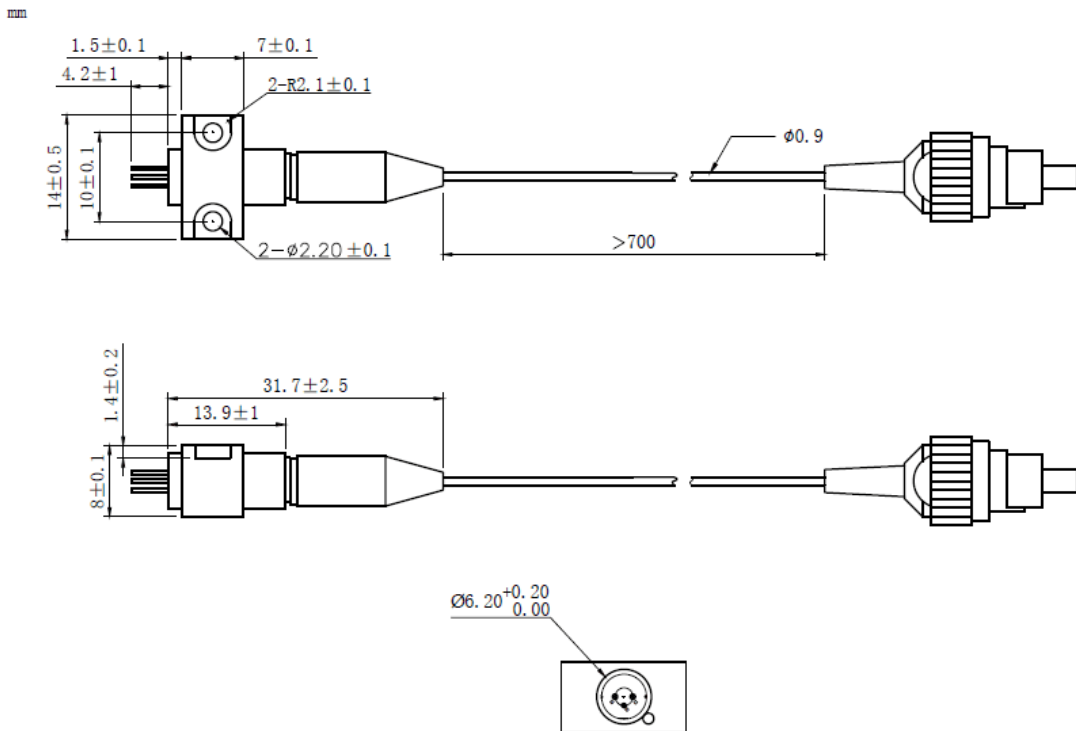
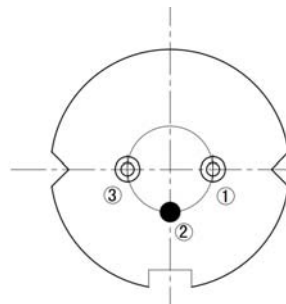

**Coaxial Package View: (Part Number: WSLP-505-010m-PM)**

**B82 Package View: (Part Number: WSLP-505-010m-PM-B)**

**PIN Bottom View:**

|          |              |
|----------|--------------|
| <b>1</b> | <b>LD(+)</b> |
| <b>2</b> | <b>GND</b>   |
| <b>3</b> | <b>LD(-)</b> |



Electrically shorten LD module and store in non-extreme conditions.  
Suggest using the constant current power supply.

