

405nm 1mW~2mW SM Coaxial Pigtailed Laser Diode | Built-in Photodiode
405nm 1mW Fiber Coupled LD with Single Mode Fiber | Violet Diode Laser Module with PD
WSLP-405-001m-4-PD
Wavespectrum Laser Group
www.wavespectrum-laser.com
en.wavespectrum-laser.com.cn

405nm Pigtailed Diode Laser 1mW/SMF			
PARAMETER	SYMBOL	VALUE	UNIT
Reverse Voltage	V_r	2.0	V
Operating Temperature	T_{op}	0~+75	°C
Storage Temperature	T_{stg}	-40~+85	°C
Lead soldering temperature (10 sec.)	T_{is}	260	°C
Features: <ul style="list-style-type: none"> ● 405nm ● 3um SM Fiber ● Coaxial or B82 Package ● Built-in Photodiode 			
Applications: <ul style="list-style-type: none"> ● Medical Laser Treatment ● Printing ● Others 			
Specifications	WSLP-405-001m-4-PD		
	Min	Type	Max
Center Wavelength@25°C	$\pm 5nm$	405nm	$\pm 10nm$
Spectral Width (FWHM)	----	2.0nm	----
Output Power	----	1mW	----
Fiber Core	3um		
Recommended Operating Temperature	25°C		
Monitor Current	----	0.2mA	----
PD MAX Reverse Voltage	----	----	30V
Fiber Connector	FC/SC/SMA905		
Fiber Length	80cm		
Threshold Current	----	20mA	----
Operating Current	----	30mA	----
Operating Voltage	----	6.0V	----
Package Style	Coaxial or B82		
PD	Built-in		

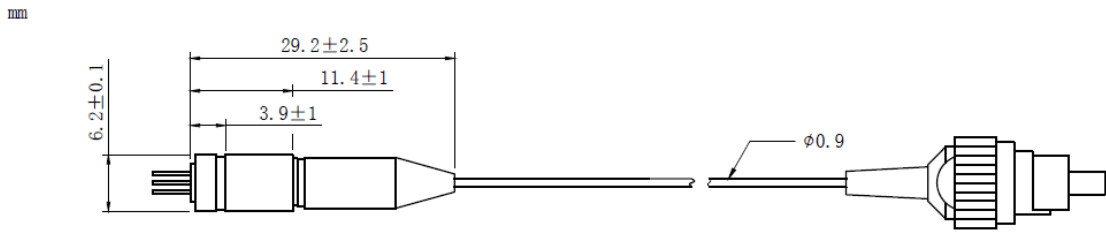
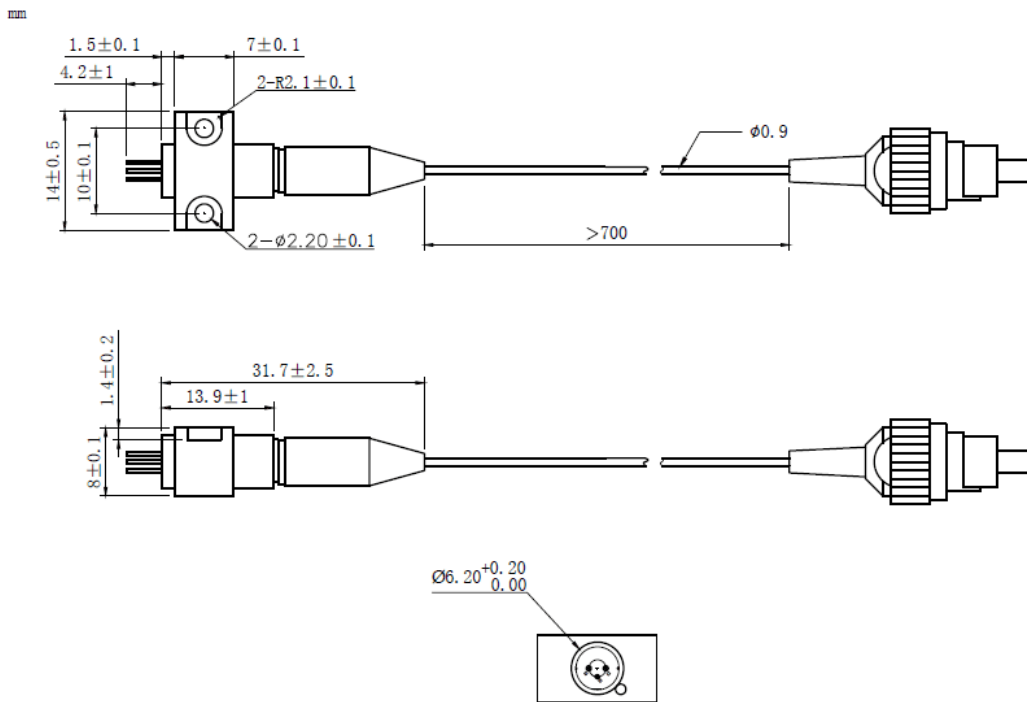
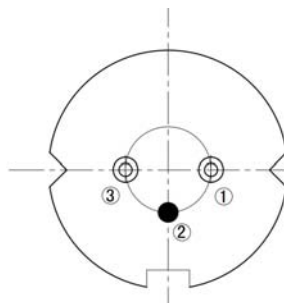

Coaxial Package View: (Part Number: WSLP-405-001m-4-PD)

B82 Package View: (Part Number: WSLP-405-001m-4-B-PD)

PIN Bottom View:

1	LD(+)
2	LD(-)&PD(-)
3	PD(+)



Electrically shorten LD module and store in non-extreme conditions.
Suggest using the constant current power supply.

